

Mapped, edited, and published by the Geological Survey
 Control by USGS and USC&GS
 Topography by photogrammetric methods from aerial photographs taken 1960 and 1963. Field checked 1964
 Polyconic projection, 1927 North American datum
 10,000-foot grid based on Mississippi coordinate system, east zone
 1000-meter Universal Transverse Mercator grid ticks, zone 16, shown in blue
 Red tint indicates areas in which only landmark buildings are shown
 To place on the predicted North American Datum 1983
 move the projection lines 16 meters south and
 5 meters east as shown by dashed corner ticks
 Revisions shown in purple compiled from aerial photographs taken 1980
 and other sources. This information not field checked. Map edited 1982
 Purple tint indicates extension of urban area

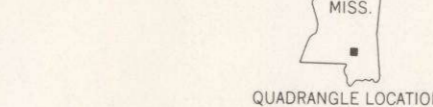
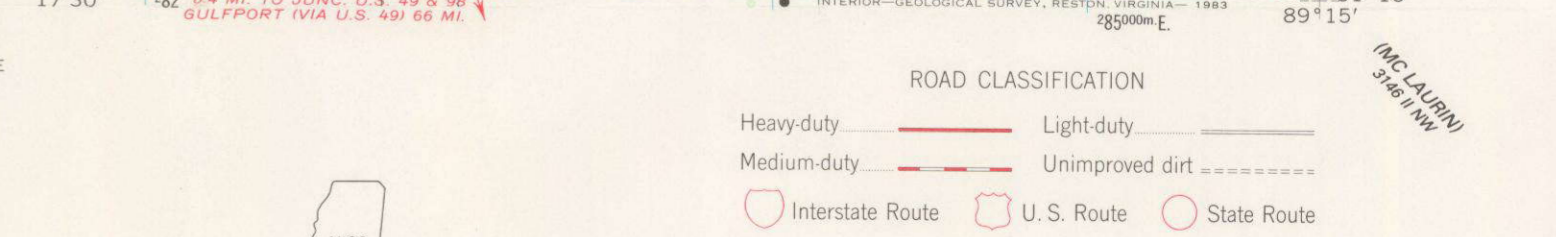
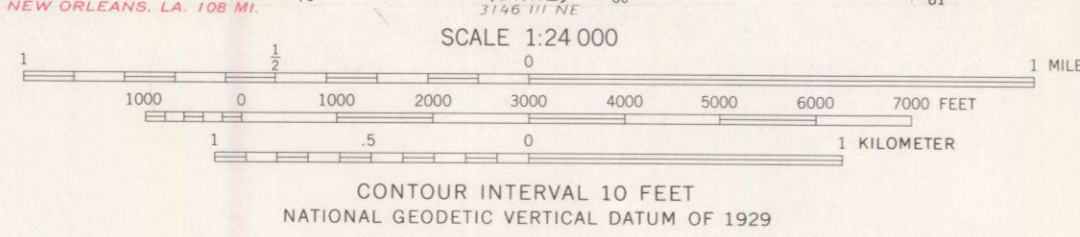
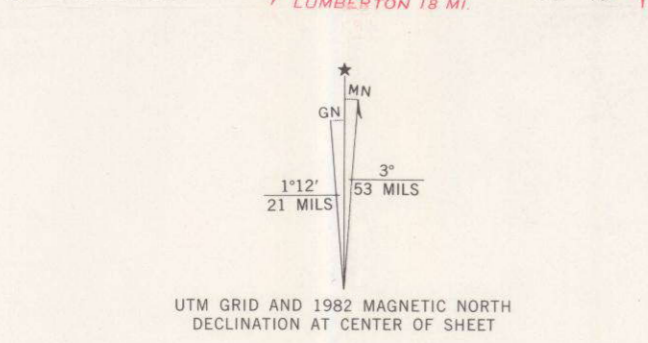

THIS MAP COMPLIES WITH NATIONAL MAP ACCURACY STANDARDS
 FOR SALE BY U. S. GEOLOGICAL SURVEY, RESTON, VIRGINIA 22092
 A FOLDER DESCRIBING TOPOGRAPHIC MAPS AND SYMBOLS IS AVAILABLE ON REQUEST

QUADRANGLE LOCATION
HATTIESBURG, MISS.
 N3115—W8915/7.5
 1964
 PHOTOREVISED 1982
 DMA 3146 IV SE—SERIES V843